

## TOWN OF THOMPSON

### Inland Wetlands Commission

815 Riverside Drive, P.O. Box 899

North Grosvenordale, CT 06255

Phone: 860-923-1852, Ext. 1

Email: [wetlands@thompsonct.org](mailto:wetlands@thompsonct.org)

Web: <https://www.thompsonct.org/>

## SPECIAL MEETING: SITE WALK

Saturday, March 11, 2023 @ 9:00 AM

The site walk will be initiated at Azud Rd just east of its intersection with  
Riverside Drive.

Please park safely along the south side of Azud Road shoulders without  
blocking the road or along Riverside Drive without blocking any driveways  
of neighboring properties.

The following site will be visited:

IWA23002, Jason Lavalley, 0 Azud Road, (Assessor's Map 67, block 53, lots  
1H and 1G), construct multifamily dwellings in 5 phases within upland review  
area with drainage discharging to wetlands/watercourses

Respectfully submitted,

Marla Butts  
Wetlands Agent

***Just a reminder - Site walks are for orientation purposes only. Please save specific questions for the meeting.***

Locus Map for IWA23002, Lavallee Proposed Apartments

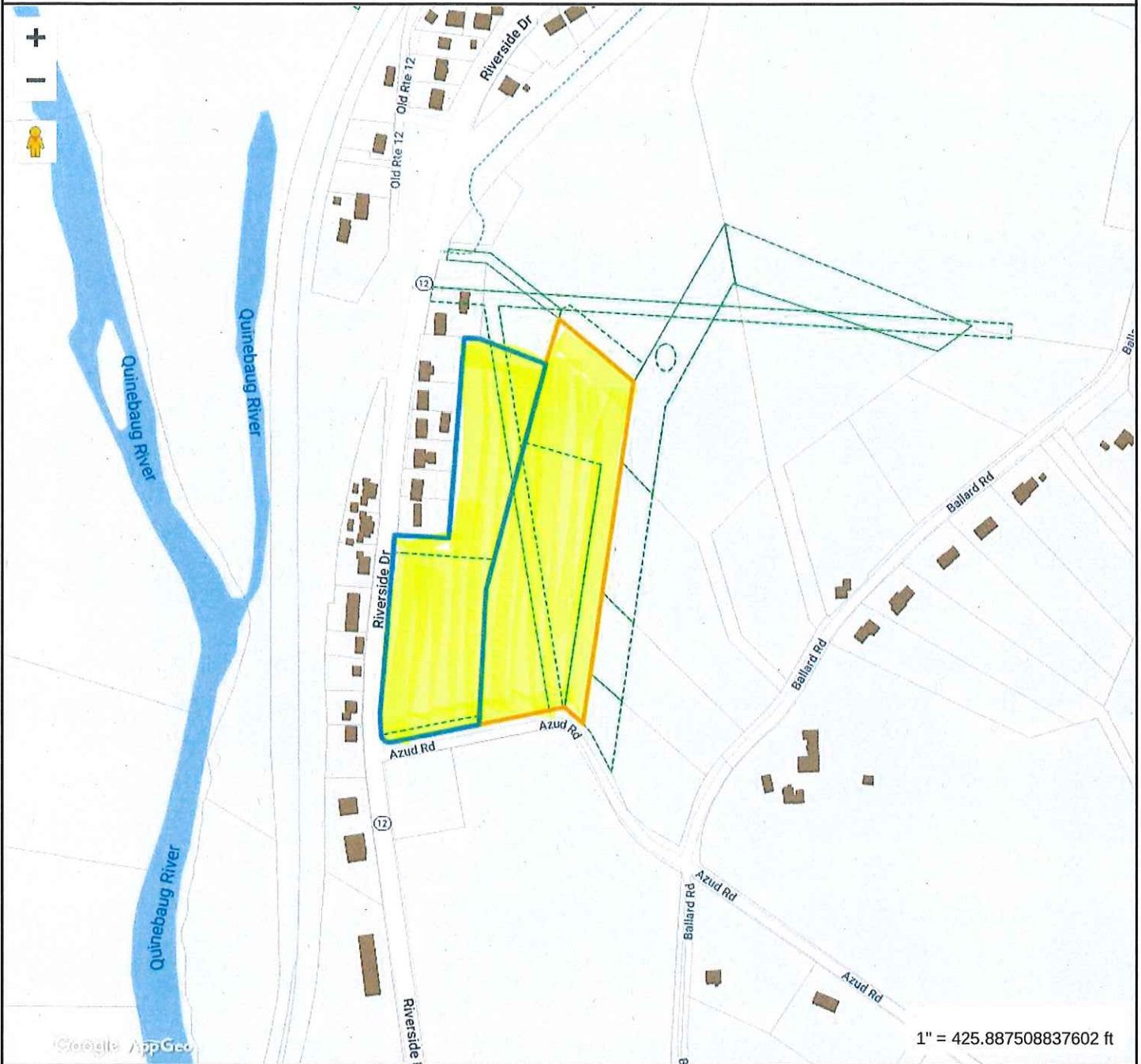

Property Information	
Property ID	104881
Location	0 AZUD RD
Owner	LAVALLEE CONSTRUCTION LLC

  
**MAP FOR REFERENCE ONLY  
NOT A LEGAL DOCUMENT**  
 Town of Thompson, CT makes no claims and no warranties, expressed or implied, concerning the validity or accuracy of the GIS data presented on this map.  
 Geometry updated December 1, 2022  
 Data updated December 1, 2022

Print map scale is approximate. Critical layout or measurement activities should not be done using this resource.